

in accordance with Comm 85, Wis. Adm. Code

Attach complete site plan on paper not less than 8 1/2 x 11 inches in size. Plan must include, but not limited to: vertical and horizontal reference point (BM), direction and Percent slope, scale or dimensions, north arrow, and location and distance to nearest road.

Please print all information.

Personal information you provide may be used for secondary purposes (Privacy Law, s. 15.04 (1) (m)).

County: Washington County	
Parcel I.D.:	
Reviewed by: <i>Di Seal</i>	Date: 12/20/04

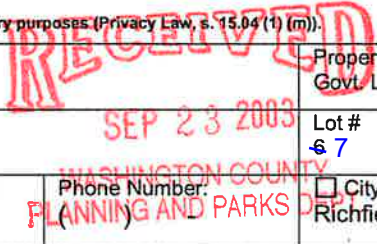

Property Owner: JBJ Development		Property Location: Govt Lot SE 1/4 NE 1/4 S 31 T 9 N - R 19 E (or) W <input checked="" type="checkbox"/>	
Property Owner's Mailing Address: W176 N9912 Rivercrest Drive		Lot # 67	Block #
City: Germantown		State: WI	Zip Code: 53022
Phone Number:		City: Richfield	Subd. Name or CSM # Cosgrove Acres
Village: <input type="checkbox"/>		Town: <input checked="" type="checkbox"/>	Nearest Road: Saddle Horse Lane

<input checked="" type="checkbox"/> New Construction	Use <input checked="" type="checkbox"/> Residential / Number of bedrooms: 4	Code derived design flow rate: 600 GPD
<input type="checkbox"/> Replacement	<input type="checkbox"/> Public or commercial - Describe:	
Parent material: Loess over glacial till		Flood Plain elevation if applicable: N/A ft.
General comments and recommendations: Mound Type System		

1 Boring # Boring Pit Ground surface elev. 1051.28 ft. Depth to limiting factor 19 in. Soil Application Rate

Horizon	Depth in.	Dominant Color Munsell	Redox Description Qu. Sz. Cont. Color	Texture	Structure Gr. Sz. Sh.	Consistence	Boundary	Roots	GPD/ft ²	
									Eff#1	Eff#2
Ap	0-10	10 YR 4/2		SiL	2 m gr	mvfr	as	2f-2m	.5	.8
Bt1	10-19	10 YR 4-3/4*		SiCL	2 m sbk	mfi	cs	2f-1m	.4	.6
Bt2	19-30	10 YR 5/4	c2d 10 YR 6/2&5/6	SiCL	2 m-co abk	mfi	dw	2f-1m	.4	.6
Bt3	30-	10 YR 5/3	c2d 10 YR 6/2&5/6	SiCL	1 f abk	mfi	--	1f	.2	.3
		*7.5YR 3/2 argillans								

2 Boring # Boring Pit Ground surface elev. 1054.74 ft. Depth to limiting factor 23 in. Soil Application Rate

Horizon	Depth in.	Dominant Color Munsell	Redox Description Qu. Sz. Cont. Color	Texture	Structure Gr. Sz. Sh.	Consistence	Boundary	Roots	GPD/ft ²	
									Eff#1	Eff#2
Ap	0-9	10 YR 4/2		SiL	2 m gr	mvfr	as	2f-2m	.5	.8
Bt1	9-14	10 YR 4-3/4		SiCL	2 m sbk	mfi	cs	2f-1m	.4	.6
Bt2	14-23	10 YR 5/4	c2d 10 YR 6/2&5/6	CL	2 m-co abk	mfi	dw	2f-1m	.4	.6
Bt3	23-50	10 YR 5/3	c2d 10 YR 6/2&5/6	SiCL	1 f abk	mfi	--	1f	.2	.3

* Effluent # 1 = BOD₅>30 ≤ 220 mg/L and TSS > 30 ≤ 150 mg/L

* Effluent # 2 = BOD₅ ≤ 30 mg/L and TSS ≤ 30 mg/L

CST Name (Please Print): David LaBott	Signature: <i>David LaBott</i>	CST Number: 71449
Address: 55 S. Third Ave. Sturgeon Bay, WI 54235	Date Evaluation Conducted: 5-6-03	Telephone Number: (920) 743 - 8211

Boring # **3** Boring
 Pit Ground surface elev. 1052.97 ft. Depth to limiting factor 23 in. Soil Application Rate

Horizon	Depth in.	Dominant Color Munsell	Redox Description Qu. Sz. Cont. Color	Texture	Structure Gr. Sz. Sh.	Consistence	Boundary	Roots	GPD/ft ²	
									Eff#1	Eff#2
Ap	0-10	10 YR 4/2		SiL	2 m gr	mvfr	as	2f-2m	.5	.8
Bt1	10-23	10 YR 5/4		SiCL	2 m sbk	mfi	cs	2f-1m	.4	.6
Bt2	23-	10 YR 5/4	c2d 10 YR 6/2&5/6	SiCL	2 m-co abk	mfi	--	2f-1m	.4	.6

Boring # **4** Boring
 Pit Ground surface elev. ft. Depth to limiting factor in. Soil Application Rate

Horizon	Depth in.	Dominant Color Munsell	Redox Description Qu. Sz. Cont. Color	Texture	Structure Gr. Sz. Sh.	Consistence	Boundary	Roots	GPD/ft ²	
									Eff#1	Eff#2

Boring # **5** Boring
 Pit Ground surface elev. ft. Depth to limiting factor in. Soil Application Rate

Horizon	Depth in.	Dominant Color Munsell	Redox Description Qu. Sz. Cont. Color	Texture	Structure Gr. Sz. Sh.	Consistence	Boundary	Roots	GPD/ft ²	
									Eff#1	Eff#2

* Effluent # 1 = BOD₅>30 ≤ 220 mg/L and TSS > 30 ≤ 150 mg/L

* Effluent # 2 = BOD₅≤ 30 mg/L and TSS ≤ 30 mg/L

The Department of Commerce is an equal opportunity service provider and employer. If you need assistance to access services or need material in an alternate format, please contact the department at 608-266-3151 or TTY 608-264-8777.



NORTH
1" = 50'

SITE PLAN

COSGROVE ACRES

LOT 67

SE 1/4 OF THE NE 1/4, SEC. 31, T. 9 N., R. 19 E.,
TOWN OF RICHFIELD, WASHINGTON COUNTY,
WISCONSIN.

PREPARED FOR:
JBJ DEVELOPMENT
W178 N9912 RIVERCREST DR.
GERMANTOWN, WI
53022

PREPARED BY:
BAUDHUIN INCORPORATED
55 S. 3RD AVENUE
P.O. BOX 105
STURGEON BAY, WI 54235
SOILS BY: DAVID LABOTT
DRAWN BY: DAVID LABOTT
CST. MPRS #71449

NOTE:
BENCHMARKS TO BE SET AND MAPS REVISED
ONCE THE ROAD IS CONSTRUCTED.

