

North

SOIL EVALUATION REPORT

in accordance with Comm 85, Wis. Adm. Code

Attach complete site plan on paper not less than 8 1/2 x 11 inches in size. Plan must include, but not limited to: vertical and horizontal reference point (BM), direction and Percent slope, scale or dimensions, north arrow, and location and distance to nearest road.

Please print all information.

Personal information you provide may be used for secondary purposes (Privacy Law, s. 15.04 (1) (m)).

County: Washington County	
Parcel I.D.:	
Reviewed by: <i>D. J. Sel</i>	Date: 12/20/04

RECEIVED

SEP 23 2003

WASHINGTON COUNTY  
PLANNING AND PARKS DEPT.

Property Owner: JBJ Development			Property Location: Govt. Lot SW 1/4 NE 1/4 S 31 T 9 N - R 19 E (or) W <input checked="" type="checkbox"/> <input type="checkbox"/>		
Property Owner's Mailing Address: W176 N9912 Rivercrest Drive			Lot # 23-1	Block #	Subd. Name or CSM # Cosgrove Acres
City: Germantown	State: WI	Zip Code: 53022	Phone Number: ( ) -	<input type="checkbox"/> City: <input type="checkbox"/> Village: <input checked="" type="checkbox"/> Town: Richfield	Nearest Road: Saddle Horse Lane

<input checked="" type="checkbox"/> New Construction	Use <input checked="" type="checkbox"/> Residential / Number of bedrooms: 4	Code derived design flow rate: 600 GPD
<input type="checkbox"/> Replacement	<input type="checkbox"/> Public or commercial - Describe:	
Parent material: Loess over glacial outwash		Flood Plain elevation if applicable: n/a ft.
General comments and recommendations: Conventional type system		

1 Boring #  Boring  Pit Ground surface elev. 1068.86 ft. Depth to limiting factor >144 in. Soil Application Rate

Horizon	Depth in.	Dominant Color Munsell	Redox Description Qu. Sz. Cont. Color	Texture	Structure Gr. Sz. Sh.	Consistence	Boundary	Roots	GPD/ft <sup>2</sup>	
									Eff#1	Eff#2
Ap	0-12	10 YR 4/2		SiL	2 m gr	mfr	as	2f-1m	.5	.8
Bt1	12-20	10 YR 5/4		SiCL	2 m abk	mfi	cs	2f-1m	.4	.6
Bt2	20-40	10 YR 5/4		SiCL	2 co abk	mfi	dw	1f-1m	.4	.6
2Bt3	40-56	10 YR 3/4		gr CL	2 m abk	mfi	gw	1f	.4	.6
2C	56-144	10 YR 6/4		vgr-cb CoS	0 sg	ml	--	--	.7	1.6

2 Boring #  Boring  Pit Ground surface elev. 1068.36 ft. Depth to limiting factor >120 in. Soil Application Rate

Horizon	Depth in.	Dominant Color Munsell	Redox Description Qu. Sz. Cont. Color	Texture	Structure Gr. Sz. Sh.	Consistence	Boundary	Roots	GPD/ft <sup>2</sup>	
									Eff#1	Eff#2
Ap	0-10	10 YR 4/2		SiL	2 m gr	mfr	as	2f-1m	.5	.8
Bt1	10-14	10 YR 4/4		CL	2 m abk	mfi	dw	2f-1m	.4	.6
2Bt2	14-28	10 YR 3/4-4		gr CL	2 m abk	mfi	gw	2f-1m	.4	.6
2C	28-120	10 YR 6/4		vgr-cb CoS	0 sg	ml	--	1f	.7	1.6

\* Effluent # 1 = BOD<sub>5</sub> > 30 ≤ 220 mg/L and TSS > 30 ≤ 150 mg/L

\* Effluent # 2 = BOD<sub>5</sub> ≤ 30 mg/L and TSS ≤ 30 mg/L

CST Name (Please Print): David LaBott(Baudhuin Inc.)	Signature: <i>Bob LaBott</i>	CST Number: 71449
Address: 55 S. Third Ave. Sturgeon Bay, WI 54235	Date Evaluation Conducted: 5-6-03	Telephone Number: ( 920 ) 743 - 8211

**3** Boring #  Boring  Pit Ground surface elev. 1068.30 ft. Depth to limiting factor >120 in Soil Application Rate

Horizon	Depth in.	Dominant Color Munsell	Redox Description Qu. Sz. Cont. Color	Texture	Structure Gr. Sz. Sh.	Consistence	Boundary	Roots	GPD/ft <sup>2</sup>	
									Eff#1	Eff#2
Ap	0-9	10 YR 4/2		SiL	2 m gr	mfr	as	2f-1m	.5	.8
Bt1	9-14	10 YR 5/4		SiCL	2 m abk	mfi	cs	2f-1m	.4	.6
Bt2	14-27	10 YR 5/4		SiCL	2 m-co abk	mfi	cs	2f-1m	.4	.6
Bt3	27-40	10 YR 4/4		CL	2 co abk	mfi	dw	1f	.4	.6
2Bt3	40-54	10 YR 3/4		gr CL	2 m abk	mfi	gw	--	.4	.6
2C	54-120	10 YR 6/4		vgr-cb CoS	0sg	ml	--	--	.7	1.6

**4** Boring #  Boring  Pit Ground surface elev. ft. Depth to limiting factor in. Soil Application Rate

Horizon	Depth in.	Dominant Color Munsell	Redox Description Qu. Sz. Cont. Color	Texture	Structure Gr. Sz. Sh.	Consistence	Boundary	Roots	GPD/ft <sup>2</sup>	
									Eff#1	Eff#2

**5** Boring #  Boring  Pit Ground surface elev. ft. Depth to limiting factor in. Soil Application Rate

Horizon	Depth in.	Dominant Color Munsell	Redox Description Qu. Sz. Cont. Color	Texture	Structure Gr. Sz. Sh.	Consistence	Boundary	Roots	GPD/ft <sup>2</sup>	
									Eff#1	Eff#2

\* Effluent # 1 = BOD<sub>5</sub>>30 ≤ 220 mg/L and TSS > 30 ≤ 150 mg/L      \* Effluent # 2 = BOD<sub>5</sub>≤ 30 mg/L and TSS ≤ 30 mg/L

The Department of Commerce is an equal opportunity service provider and employer. If you need assistance to access services or need material in an alternate format, please contact the department at 608-266-3151 or TTY 608-264-8777.

SADDLE HORSE LANE

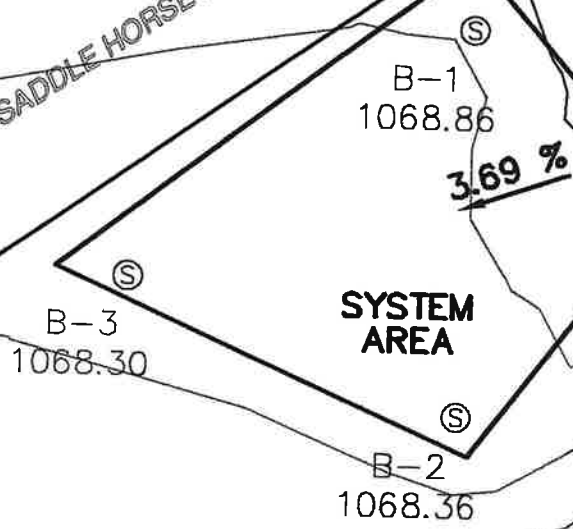

SYSTEM AREA

3.69 %

B-1  
1068.86

B-3  
1068.30

B-2  
1068.36

# SITE PLAN

## COSGROVE ACRES

LOT 23 1  
SW 1/4 OF THE NE 1/4, SEC. 31, T. 9 N., R. 19 E.,  
TOWN OF RICHFIELD, WASHINGTON COUNTY,  
WISCONSIN.

~~23~~ 1

10.55 AC.

PREPARED FOR:  
JBJ DEVELOPMENT  
W178 N9912 RIVERCREST DR.  
GERMANTOWN, WI  
53022

PREPARED BY:  
BAUDHUIN INCORPORATED  
55 S. 3RD AVENUE  
P.O. BOX 105  
STURGEON BAY, WI 54235  
SOILS BY: DAVID LABOTT  
DRAWN BY: DAVID LABOTT  
CST, MPRS #71449



NORTH  
1" = 50'

NOTE:  
BENCHMARKS TO BE SET AND MAPS REVISED  
ONCE THE ROAD IS CONSTRUCTED.