

Woodridge



Woodridge



Improvements...

Every lot includes paved streets, underground electrical, telephone and natural gas service (all lots require an onsite private well and septic system).

Schools...

Germantown School District

- Amy Belle School (Kindergarten through Grade 5)
- Kennedy Middle School (Grades 6 through 8)
- Germantown High School (Grades 9 through 12)

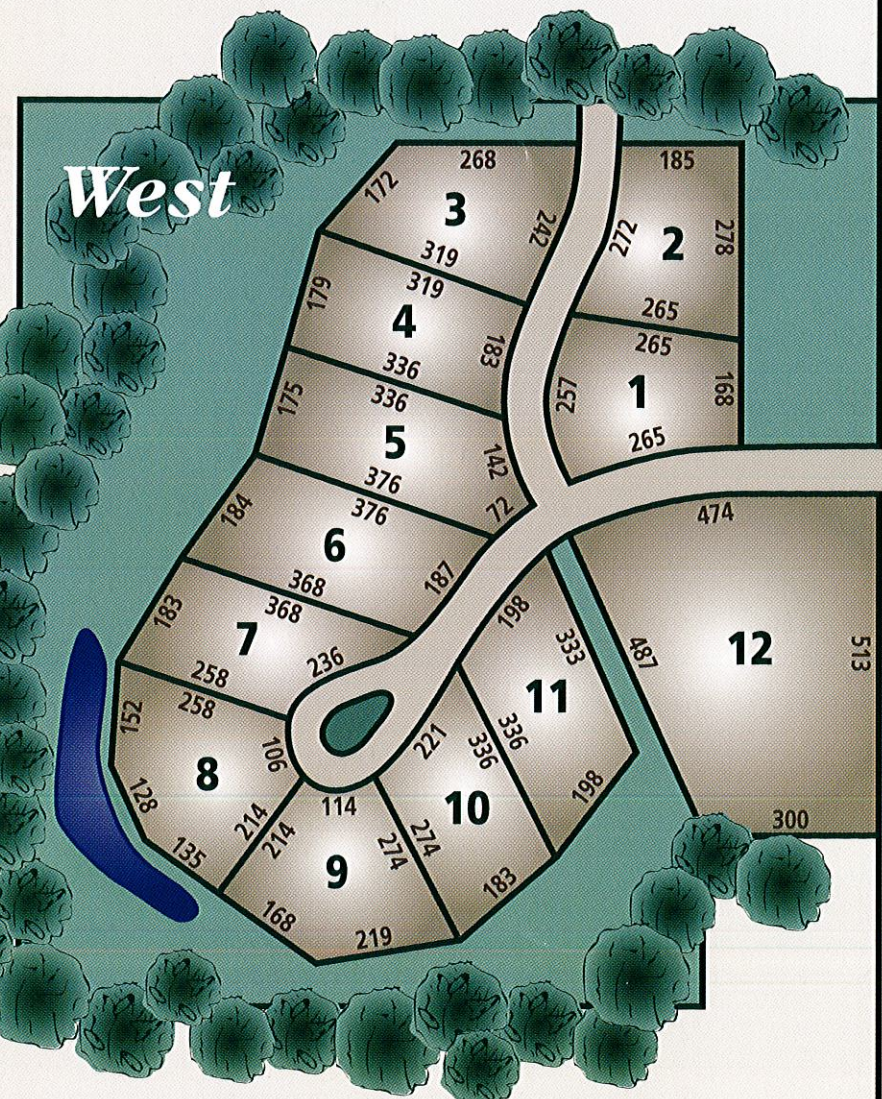

Architectural Guidelines...

To preserve the property values and enhance the beauty of the neighborhood, the following architectural guidelines will be enforced:

- The minimum size of each residence shall be 2000 square feet for a one story home and 2400 square feet for a two story home.
- Only natural materials such as brick, stone, stucco, or wood may be used on exterior walls.
- The treatment of window trim and/or shutters must be consistent on all sides of the home.
- All homes must have a side entry attached garage with a minimum two car capacity.
- All driveways must be paved. Outbuildings will be permitted.
- All homes shall have a minimum of 8/12 roof pitch, with dimensional shingles.
- Minimum building set back is 50 feet from any street right of way.
- Minimum side yard is 25 feet. Minimum rear yard is 40 feet.
- An approved outdoor electrical post lamp and address plaque must be installed at the time of home construction.

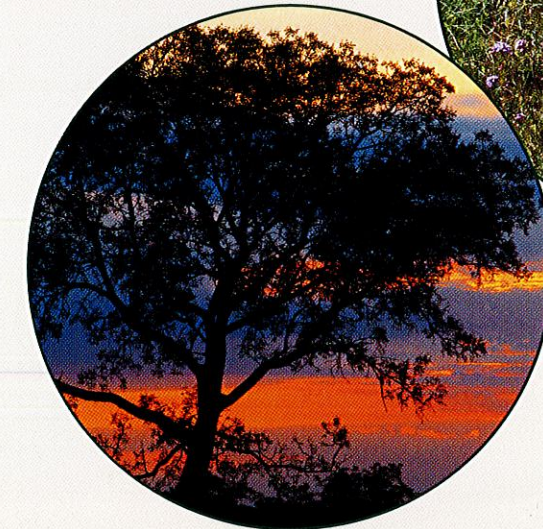

Lot dimensions are approximate and subject to change.

Location... Woodridge (*East and West*)



Lot Information...



J.B.J. Companies
 (262) 255-1800
www.jbjcompanies.com

M&I Marshall & Isley Bank

For all your banking needs call
Darvin Behm, VP Mortgage Lender
 W156 N11150 Pilgrim Road
 Germantown, Wisconsin 53022
800-571-0157 or 262-253-6197